

Model No.: **GN13G**

FOR INDUSTRIAL MARKET ONLY

NO MERCURY ADDED	
Description	: Mercury Free Extra Heavy Duty Battery, D Size
Chemical System	: Zinc Chloride
Nominal Voltage	: 1.5 Volts
Nominal Dimensions	: $\varnothing 34.2$ mm x 61.5 mm
Terminals	: Protruded positive (+) and flat negative (-) contacts
Jacket	: Metal jacket with PVC insulation
Applications	: All electronic devices, e.g. transistor radios, cassette recorders, toys, alarm clocks, portable fans, portable hand-tools.
Warranty Period	: 36 months
Average Weight	: 97g

Cross References:

GP	JIS	IEC	Eveready
13G	R20P	R20P	1250

Typical Service Life:

Discharge Resistance	Discharge Condition	End Point Voltage	Service Life
2.2 Ohms	1 Hr/ Day	0.8V	8.3 Hrs

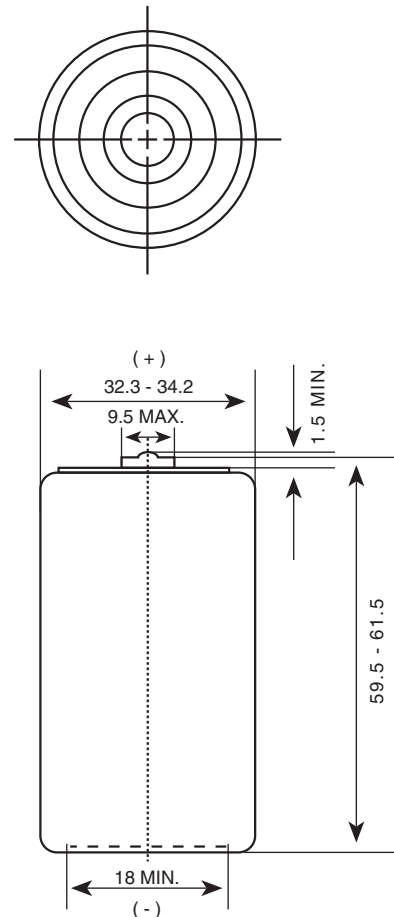
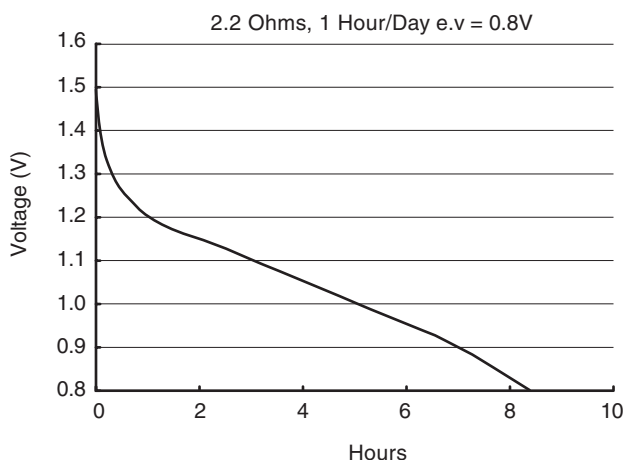

Unit : mm

The information (subject to change without prior notice) contained in this document is for reference only and should not be used as a basis for product guarantee or warranty. For applications other than those described here, please consult your nearest GP Sales and Marketing Office or Distributors.

Model No.: **GN14G**

FOR INDUSTRIAL MARKET ONLY

NO MERCURY ADDED	
Description	: Mercury Free Extra Heavy Duty Battery, C Size
Chemical System	: Zinc Chloride
Nominal Voltage	: 1.5 Volts
Nominal Dimensions	: $\varnothing 26.2$ mm x 50 mm
Terminals	: Protruded positive (+) and flat negative (-) contacts
Jacket	: Metal jacket with PVC insulation
Applications	: All electronic devices, e.g. transistor radios, cassette recorders, toys, alarm clocks, lighting, torches & portable fans.
Warranty Period	: 36 months
Average Weight	: 47.8g

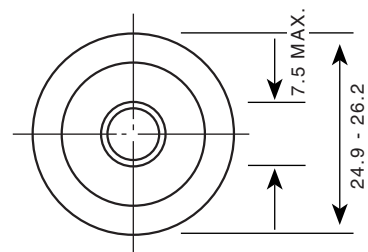

Cross References:

GP	JIS	IEC	Eveready
14G	R14P	R14P	1235

Typical Service Life:

Discharge Resistance	Discharge Condition	End Point Voltage	Service Life
3.9 Ohms	1 Hr/ Day	0.8V	8.2 Hrs

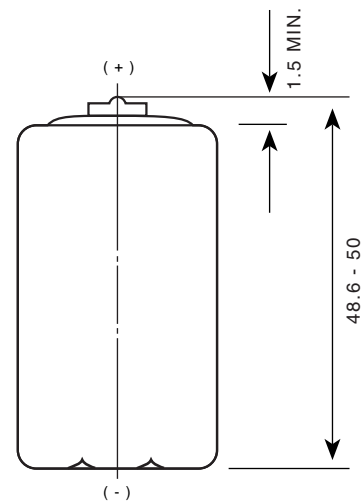
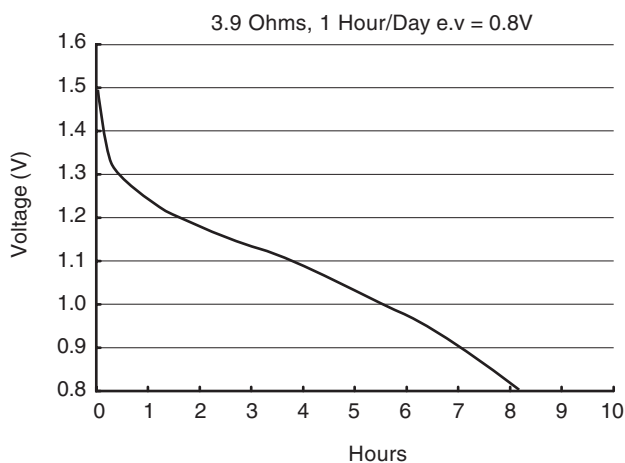

Unit : mm

The information (subject to change without prior notice) contained in this document is for reference only and should not be used as a basis for product guarantee or warranty. For applications other than those described here, please consult your nearest GP Sales and Marketing Office or Distributors.

Model No.: **GN15G**

FOR INDUSTRIAL MARKET ONLY

NO MERCURY ADDED	
Description	: Mercury Free Extra Heavy Duty Battery, AA Size
Chemical System	: Zinc Chloride
Nominal Voltage	: 1.5 Volts
Nominal Dimensions	: \varnothing 13.9 mm x 50.0 mm
Terminals	: Protruded positive (+) and flat negative (-) contacts
Jacket	: Metal jacket with PVC insulation
Applications	: All electronic devices, e.g. toys, data banks, audio appliances, calculators, remote controls, paging machines.
Warranty Period	: 36 months
Average Weight	: 17.3g

Cross References:

GP	JIS	IEC	Eveready
15G	R6P	R6P	1215

Typical Service Life:

Discharge Resistance	Discharge Condition	End Point Voltage	Service Life
10 Ohms	1 Hr/ Day	0.9V	6.5 Hrs

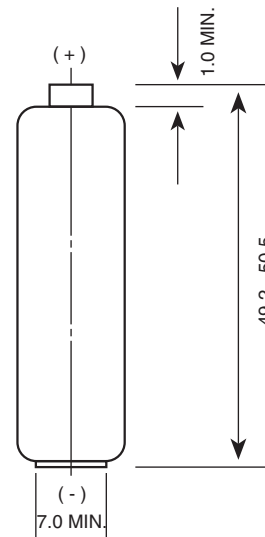
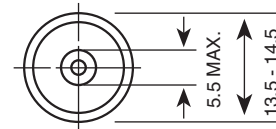
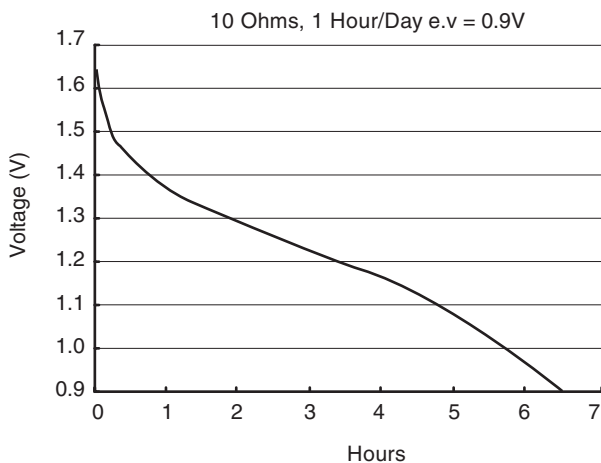

Unit : mm

The information (subject to change without prior notice) contained in this document is for reference only and should not be used as a basis for product guarantee or warranty. For applications other than those described here, please consult your nearest GP Sales and Marketing Office or Distributors.

Model No.: **GN24G**

FOR INDUSTRIAL MARKET ONLY

NO MERCURY ADDED	
Description	: Mercury Free Extra Heavy Duty Battery, AAA Size
Chemical System	: Zinc Chloride
Nominal Voltage	: 1.5 Volts
Nominal Dimensions	: ϕ 10.5 mm x 44.5 mm
Terminals	: Protruded positive (+) and flat negative (-) contacts
Jacket	: Printed PVC shrink sleeve
Applications	: All electronic devices, e.g. toys, data banks, audio appliances, calculators, remote controls, paging machines.
Warranty Period	: 36 months
Average Weight	: 8.5g

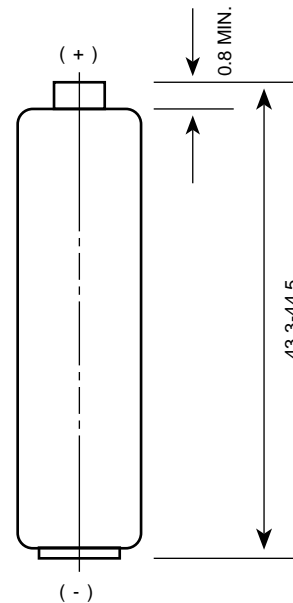
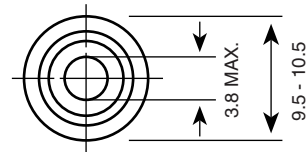

Unit : mm

Cross References:

GP	JIS	IEC	Eveready
24G	R03	R03	1212

Typical Service Life:

Discharge Resistance	Discharge Condition	End Point Voltage	Service Life
10 Ohms	1 Hr/ Day	0.9V	3 Hrs

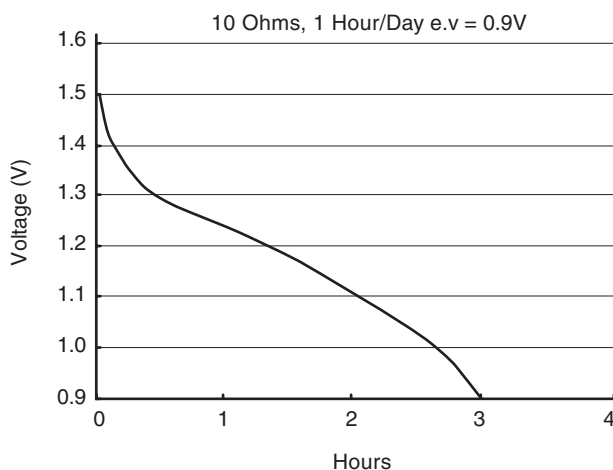

The information (subject to change without prior notice) contained in this document is for reference only and should not be used as a basis for product guarantee or warranty. For applications other than those described here, please consult your nearest GP Sales and Marketing Office or Distributors.

GP Batteries

Data Sheet

Model No.: GP312G

NO MERCURY ADDED

Description : Mercury Free Extra Heavy Duty
 Chemical System : Zinc Chloride
 Nominal Voltage : 4.5 Volts
 Nominal Dimensions : 22.0 mm x 62.0 mm x 67.0 mm
 Terminals : Brass positive(+) and brass negative(-)
 Jacket : Plastic jacket, ultrasonic welded
 Applications : Head lamp, bicycle lamp & pocket lamp.
 Shelf Life : 24 months
 Average Weight : 115gm
 Date Code : Unless otherwise specified, every battery will carry an expiry date code for 24 months. (e.g. a battery manufactured on January 2000 will carry an expiry code of 01-02.) 01 stands for January, 02 stands for 2002

Estimated Service:

Discharge Resistance	Discharge Condition	End Point Voltage	Service Life
220 Ohms	4 Hrs/ Day	2.7V	108 Hrs
20 Ohms	1 Hr/Day	2.7V	370 Mins

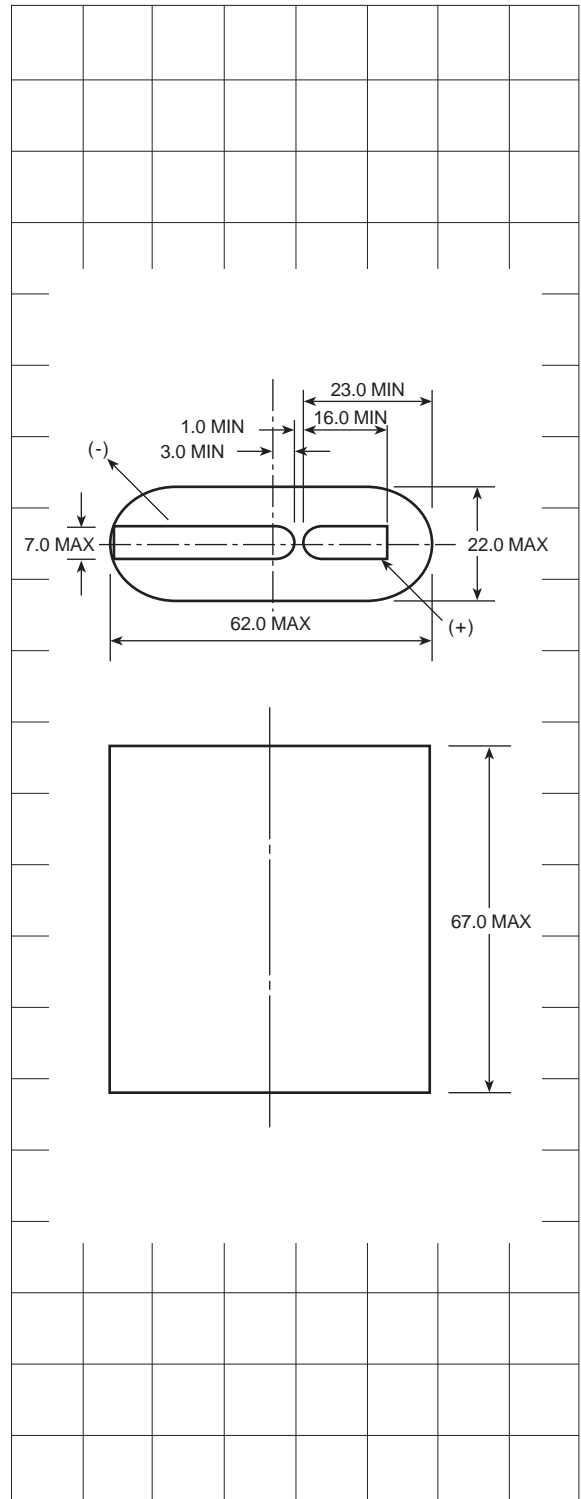
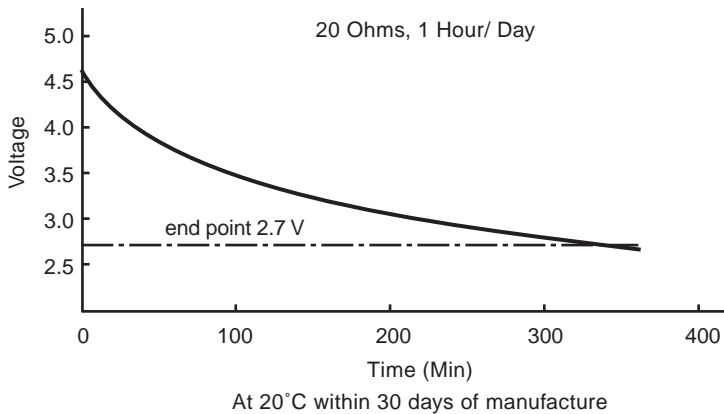

Cross References:

GP	IEC
312G	3R12

GP Batteries

Data Sheet

Model No.: GP908G

NO MERCURY ADDED

Description : Mercury Free Extra Heavy Duty 6V Lantern Battery
 Chemical System : Zinc Chloride
 Nominal Voltage : 6.0 Volts
 Nominal Dimensions: 66 mm x 66 mm x 111 mm
 Terminals : Coil Spring
 Jacket : Black Plastic Jacket, Ultrasonic Welded
 Applications : Lanterns, road lamps and other heavy duty lighting devices
 Shelf Life : 12 months
 Average Weight : 600g
 Date Code : Unless otherwise specified, every battery will carry an expiry date code for 12 months. (e.g. a battery manufactured on January 1999 will carry an expiry code of 01-00.) 01 stands for January, 00 stands for 2000

Estimated Service :

Discharge Resistance	Discharge Condition	End Point Voltage	Service Life
6.8 Ohms	30 Mins/ Hr 8 Hrs/ Day	3.6V	380 Mins
8.2 Ohms	30 Mins/ Day	3.6V	11 Hrs
120 Ohms	12 Hrs/ Day	3.6V	230 Hrs

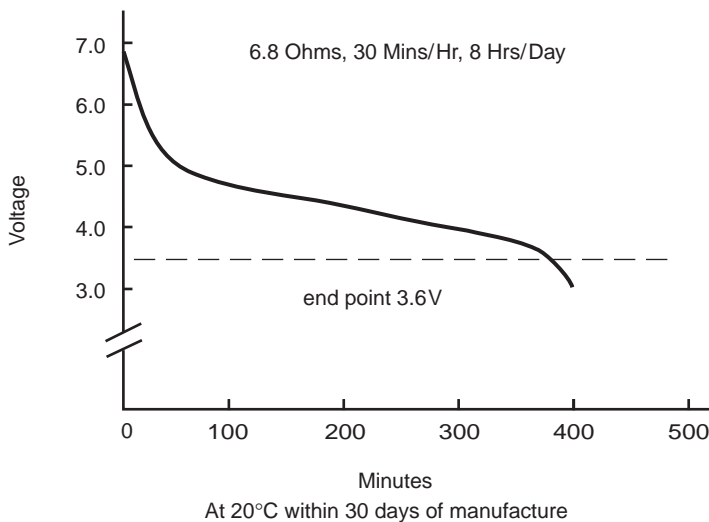

Cross References:

GP	JIS	IEC	Eveready	Duracell/Mallory
908G	4F	4R25	509	M908

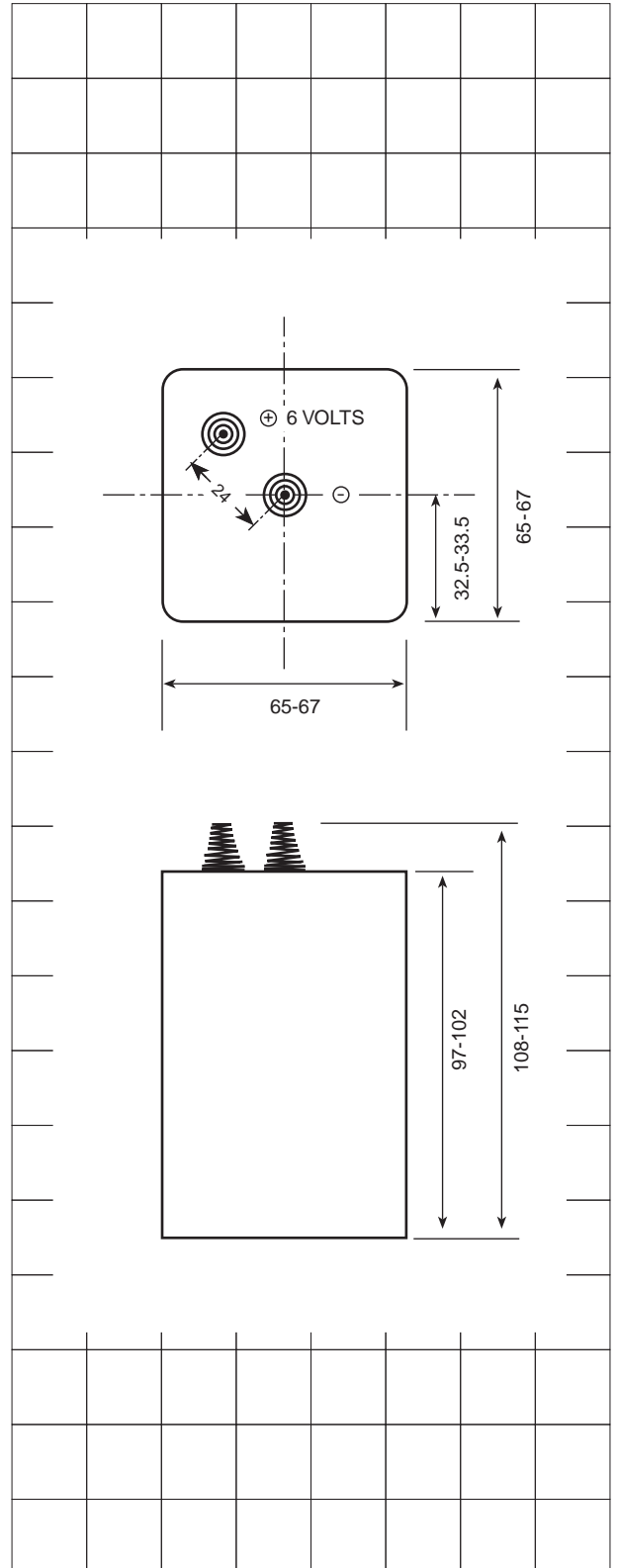

NO MERCURY ADDED	
Description	: Mercury Free Layer Built Extra Heavy Duty Battery
Chemical System	: Carbon Zinc
Nominal Voltage	: 9.0 Volts
Nominal Dimensions	: 26.5 mm x 17.5 mm x 48.5 mm
Terminals	: Standard snap fastener stud (+) and socket (-)
Jacket	: Metal jacket
Applications	: All electronic devices, e.g. toys, remote controls.
Warranty Period	: 36 months
Average Weight	: 35.7g

Model No.: **GN1604G**

FOR INDUSTRIAL MARKET ONLY

Cross References:

GP	JIS	IEC	Eveready
1604G	6F22	6F22	1222

Estimated Service:

Discharge Resistance	Discharge Condition	End Point Voltage	Service Life
620 Ohms	2 Hrs/ Day 7 Days/ Week	5.40V	30.0 Hrs
180 Ohms	30 Mins/ Day 7 Days/ Week	4.80V	8.6 Hrs

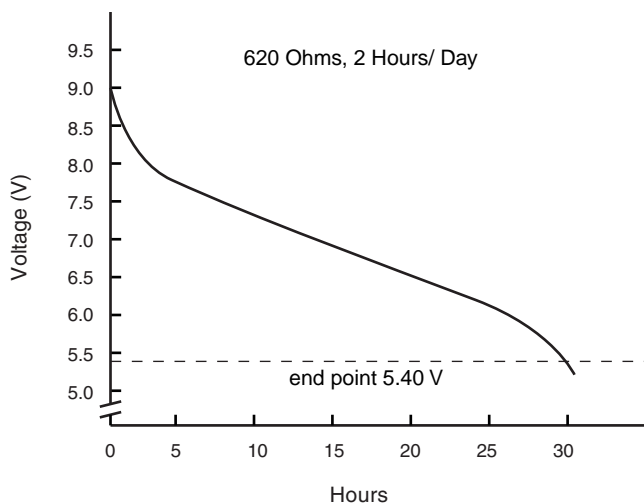

At 20°C within 30 days of manufacture

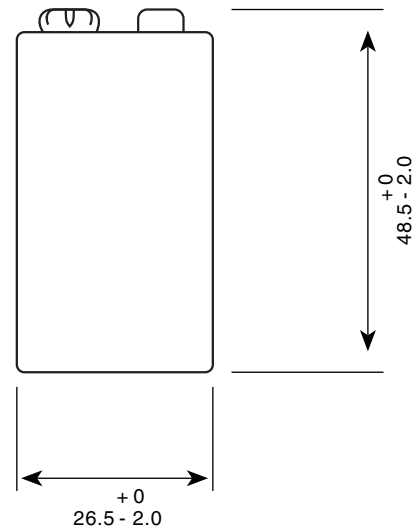
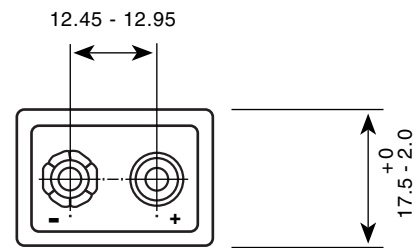

Unit : mm

The information (subject to change without prior notice) contained in this document is for reference only and should not be used as a basis for product guarantee or warranty. For applications other than those described here, please consult your nearest GP Sales and Marketing Office or Distributors.